

## 07.1-1842 Testing vacuum cutoff for leaks

Operation no. of operation texts and work units or standard texts and flat rates:  
07-1842

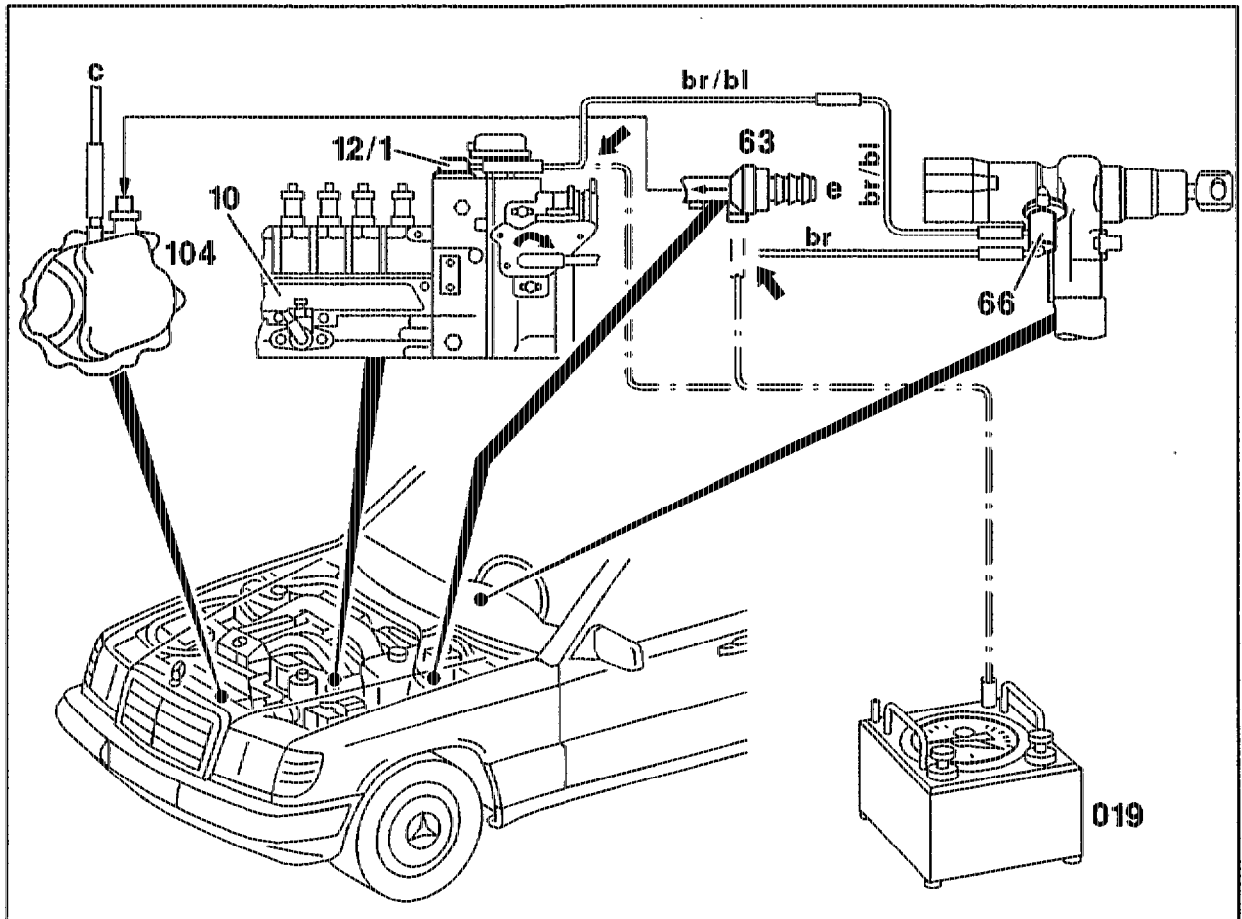

P07-6477-57

10	In-line injection pump	c	Other consumers
12/1	Stop vacuum unit	e	To brake booster
63	Brake check valve	019	Vacuum tester
66	Glow start switch valve		
104	Vacuum pump		

Glow start switch	.....	move into position "0".
Suction lining (br)	.....	detach from connector of check valve (63).
Vacuum tester (019)	.....	connect to suction lining (br) (arrow) and pressurize with vacuum of 400 + 50 mbar. If a vacuum drop of more than 6 mbar/min occurs at vacuum tester (019), test the system for leaks.

**Testing**

Vacuum line (br/bl) to glow starter switch valve  
(66) .....

Vacuum tester (019) .....

All detached vacuum lines .....

detach and seal. Pressurize with vacuum; if leak exists, replace glow starter switch valve (66) (46-8010).

connect to vacuum line (br/bl) to stop vacuum unit (12/1). Pressurize with vacuum; if leak exists, replace stop vacuum unit (12/1) (07.1-8618).

connect.

**Special tool**

