

07.1-6750 Servicing, adjusting injection nozzles

Preceding work:
 Removing and installing injection nozzles (07.1-6830).
 Testing injection nozzles (07.1-6712).

Operation no. of operation texts and work units or standard texts
 and flat rates:
 07-6750

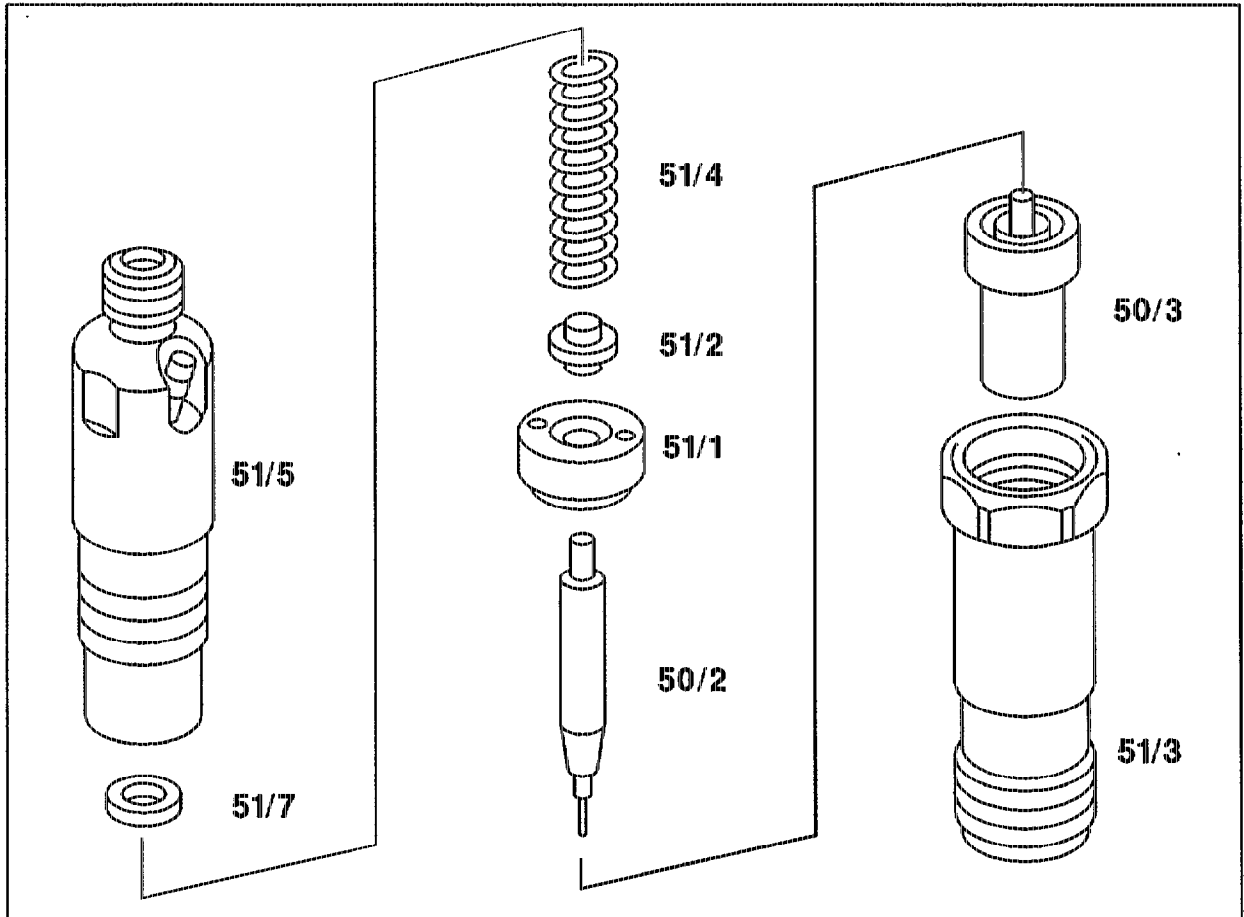

P07-6488-57

Injection nozzles	disassemble, assemble. To do this, clamp retaining body (51/5) in vice using protective jaws. Ensure that the leak oil lines are not damaged.
Nozzle tensioning nut (51/3)	unscrew, screw on. Tightening torque 70-80 Nm.
Nozzle needle (50/2)	remove, install. Perform visual and sliding check. To do this, immerse nozzle in filtered diesel fuel. When nozzle body is held upright, nozzle needle must slide down toward nozzle seat as a result of its own weight. If damaged, replace nozzle needle (50/2) and nozzle body (50/3) only as a set.

Combustion residues on nozzle body (50/3)	remove.
Intermediate disk (51/1)	dress on dressing plate.
Thrust pin (51/2)	remove, insert. Tip must face toward top part.
Compression spring (51/4)	remove, insert.
Ejection pressure	adjust by inserting shim (51/7).

Specification:

115 + 8 bar for new or newly adjusted nozzle; at least 110 bar for used nozzle.

Ejection pressure higher or lower depending on thickness of shim.

0.02 mm corresponds to pressure difference of about 2–3.

Special tools

