

42-0818 Removal and installation of ASR pressurizing pump (M15)

Operation no. of operation texts and work units or standard texts and flat rates

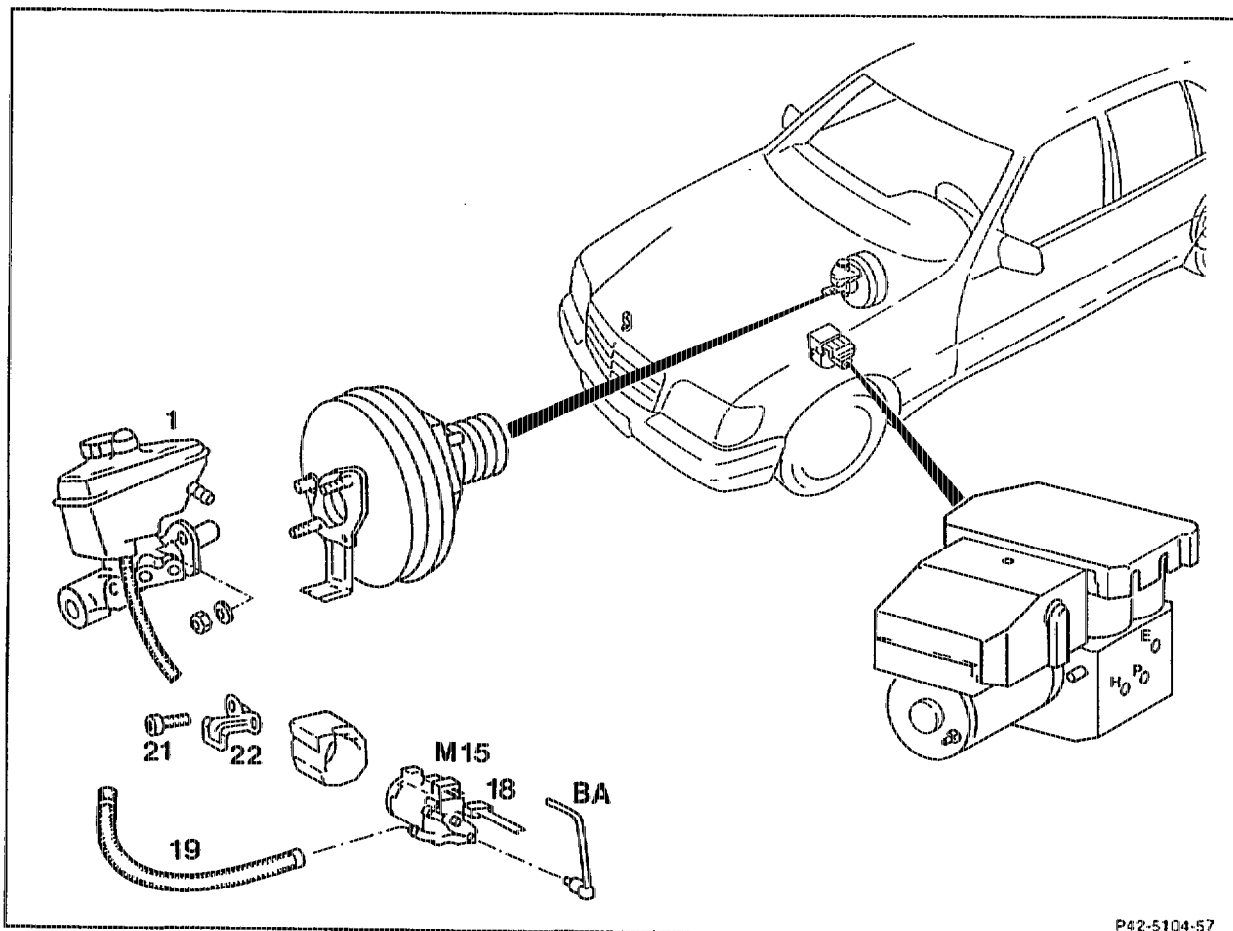

P42-5104-57

Shown on model 140

Ignition	OFF.
Electrical connector	detach, attach.
Hose (19) from the brake fluid reservoir to the ASR pressurizing pump (M15)	pinch off using clamping screw 000 589 40 37 00. Remove clamping screw downwards. Take down clamping screw.
Hydraulic line "BA" (20)	unscrew from, screw on to the ASR pressurizing pump (M15).
Model 140	
Tandem master cylinder (1)	remove, install (42-310).
Hexagon socket screw (21)	unscrew, screw in.
Mounting (22)	detach, attach.

ASR pressurizing pump (M15)	withdraw slightly forwards, swivel upright and lift out, replace.
Hose (19)	detach from, attach to the ASR pressurizing pump (M15).
ASR hydraulics	bleed and check for leaks (42-010).
ASR hydraulics test program	perform (42-0824 or Diagnosis Manual - Chassis).
Models 124.034/36, 129.067/076 and 140	
Fault memory	readout and erase in accordance with Diagnosis Manual - Chassis.

Special tools

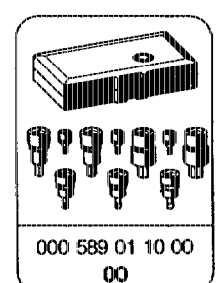
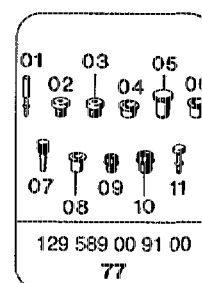
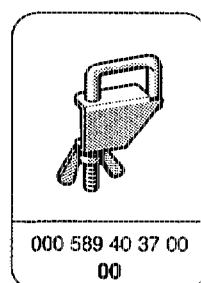
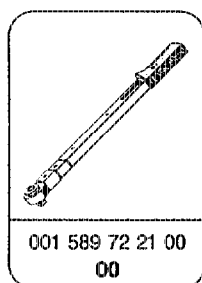
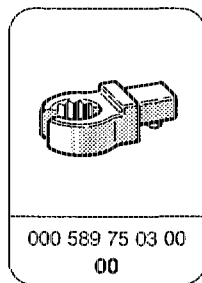

Note

Only use commercially available double ended flat flare nut ring wrench to slacken the brake lines.

Seal hydraulic lines and connections with blind plugs.

Installation note

When installing the hydraulic lines, clean sealing surfaces of swarf and dirt.

The plug connection (18) must engage audibly when connecting.