

42-0819 Removal and installation of accumulator

Operation no. of operation texts and work units or standard texts and flat rates

A. Models 124, 126, 201

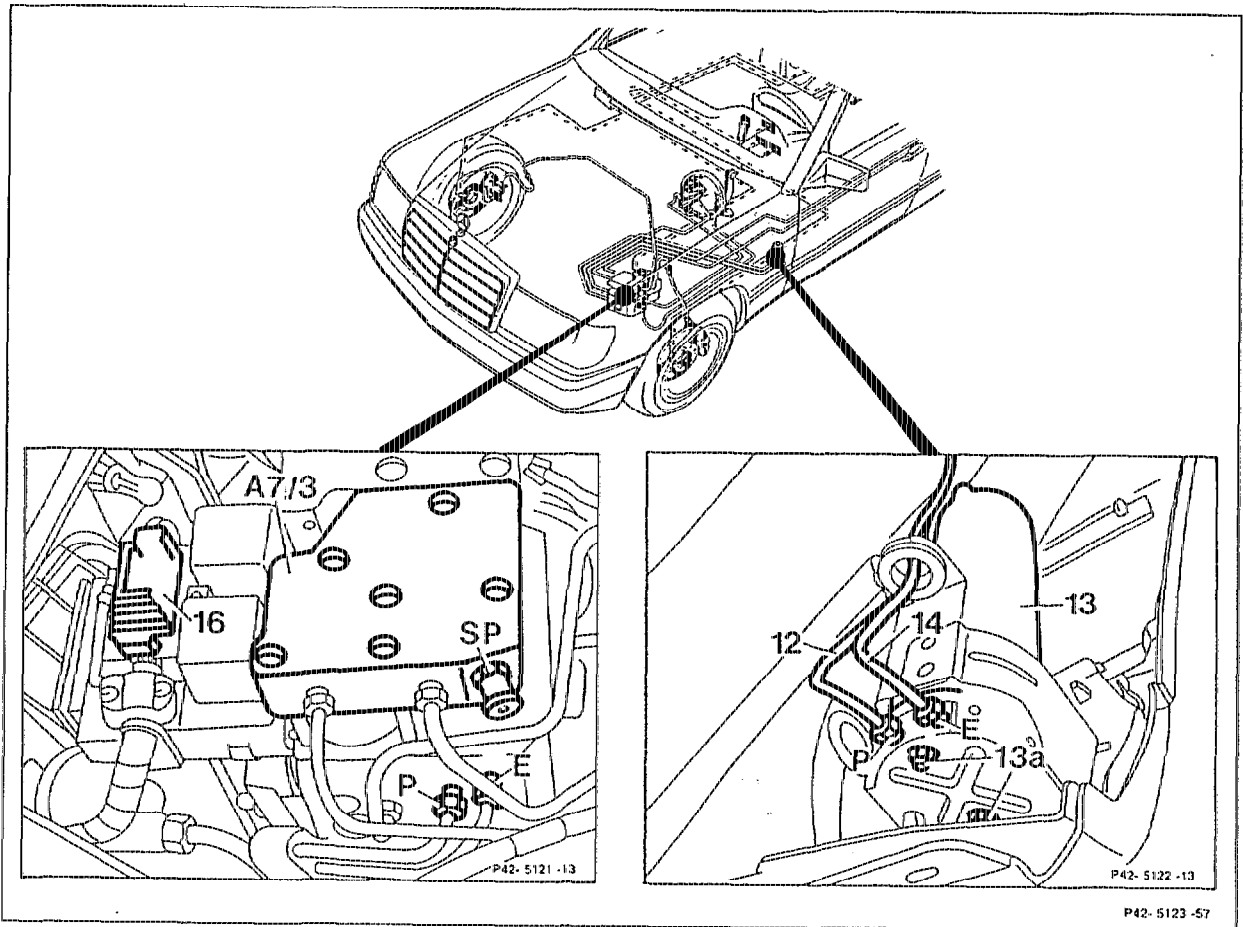

Ignition

Hydraulic system

Cover hoods

OFF.

depressurize. Open bleed screw "SP" at ASR hydraulic unit (A7/3) approx. 1 turn, drain entire accumulator contents into the receptacle for brake fluid.

unclip or remove after slackening the screw, put on.

Electrical connector	detach from the ASR hydraulic unit (A7/3), replace. Follow installation note.
Hydraulic lines (12, 14)	unscrew, screw on at the connections "P" and "E" on the ASR hydraulic unit (A7/3). Only use 9 x 11 mm double ended flat flare nut ring wrench for slackening, 15 Nm. Seal connections.
Steering wheel	turn to the left as far as the stop.
Left front wheelhouse lining	remove, install.
Nuts (13a)	unscrew, screw on.
Pressure accumulator (13) with lines (12 and 14) .	withdraw to the front, install.
ASR hydraulics	bleed and check for leaks (42-010).
ASR hydraulics test program	perform (42-0824 or Diagnosis Manual - Chassis).
Models 124.034/036	
Fault memory	readout and erase in accordance with Diagnosis Manual - Chassis.

Special tools

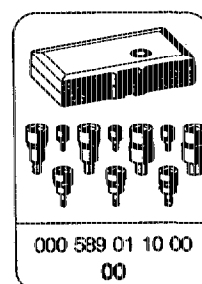
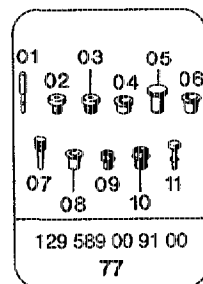
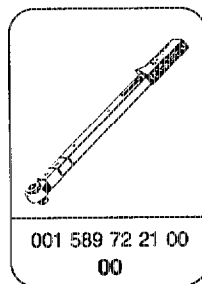
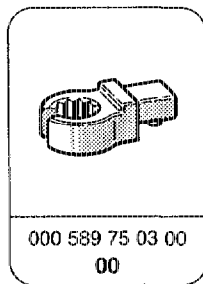

Note

Only use commercially available double ended flat flare nut ring wrench to slacken the brake lines.

Seal hydraulic lines and connections with blind plugs.

Installation note

When installing the hydraulic lines, clean sealing surfaces of swarf and dirt.

The plug connection (16) must engage audibly when connecting.

Markings on the ASR hydraulic unit (A7/3):

- P Pump
- E Pressure accumulator input
- SP Bleed screw

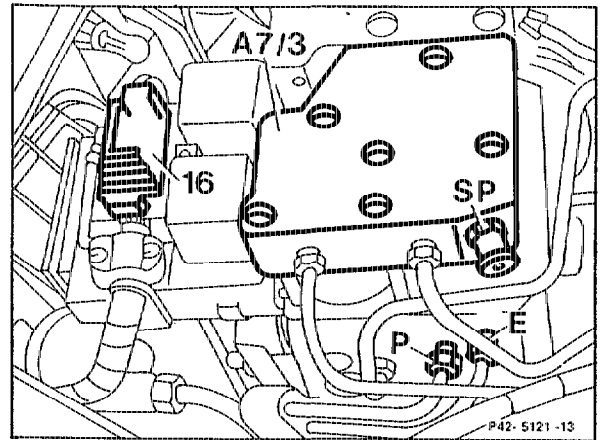

Check line routing:

- Pressure accumulator connection "P" - ASR hydraulic unit (A7/3) connection "P",
- Pressure accumulator connection "E" - ASR hydraulic unit (A7/3) connection "E".

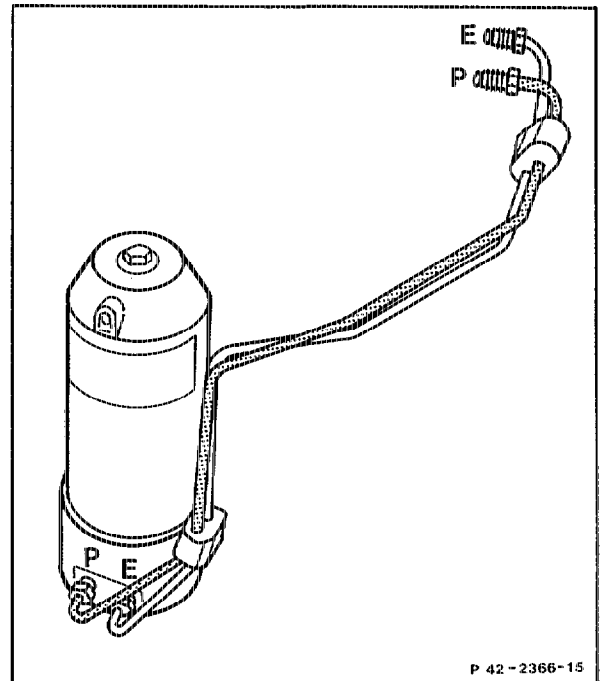

B. Model 129

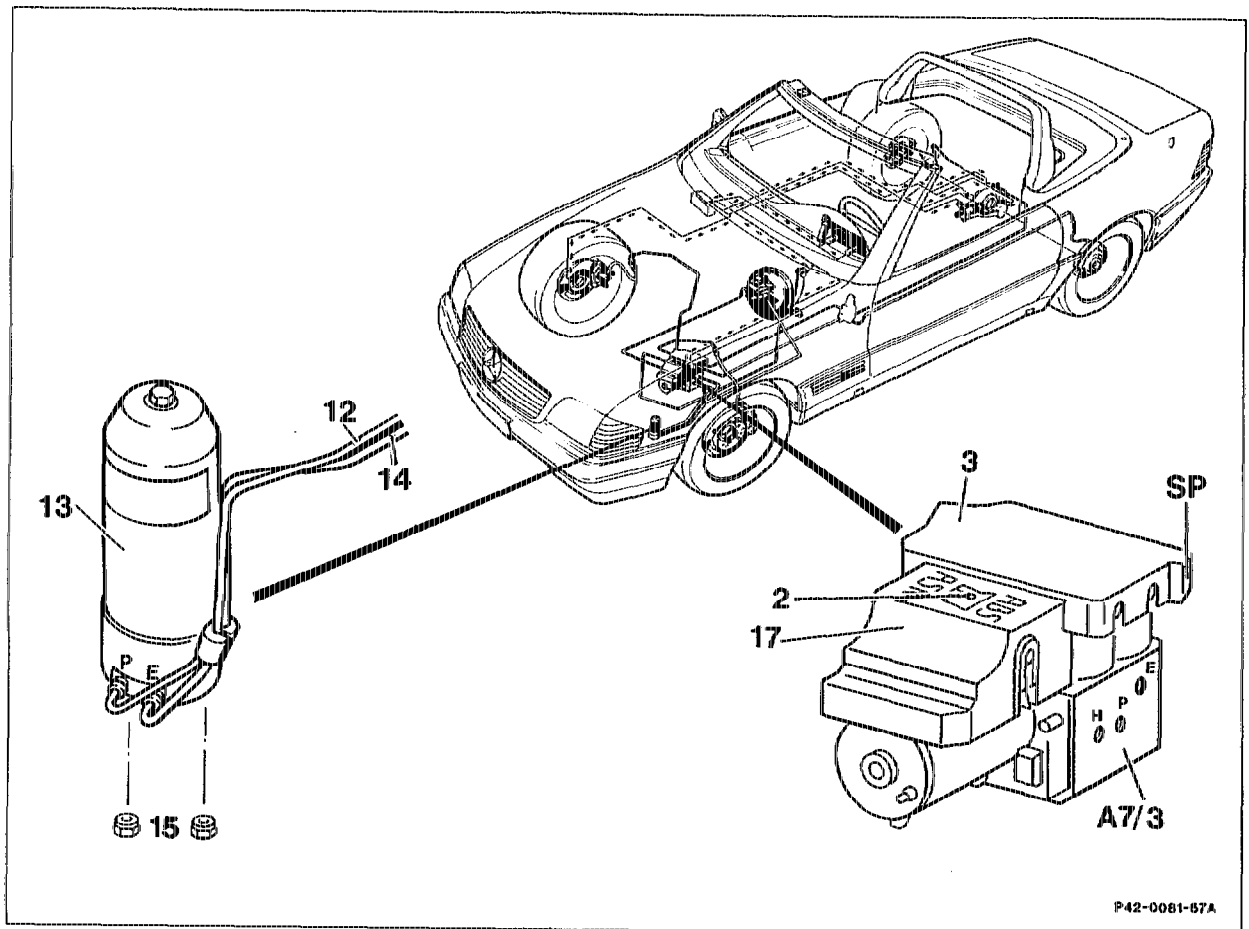

P42-0081-57A

Ignition	OFF.
Hydraulic system	depressurize. Open bleed screw "SP" on ASR hydraulic unit (A7/3) approx. 1 turn, drain complete contents of accumulator into the receptacle for brake fluid.
Cover hoods (3 and 17)	unclip or remove after slackening the screw (2), put on.
Electrical connector	detach from ASR hydraulic unit (A7/3), replace. Follow installation note
Hydraulic lines (12, 14)	Unscrew from, screw on to the connections "P" and "E" on the ASR hydraulic unit (A7/3). Only use 9 x 11 mm double ended flat flare nut ring wrench for slackening, 15 Nm. Seal connections.

Nuts (15)	unscrew, screw in at vehicle floor.
Pressure accumulator (13)	remove, install with the lines (12 and 14) using a rotary movement upwards. Before installation, align the lines on pressure accumulator and tighten.
ASR hydraulics	bleed and check for leaks (42-010).
ASR hydraulics test program	perform (42-0824, or Diagnosis Manual - Chassis)
Model 129.067/076	
Fault memory	readout and erase in accordance with Diagnosis Manual - Chassis.

Special tools

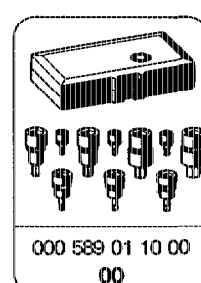
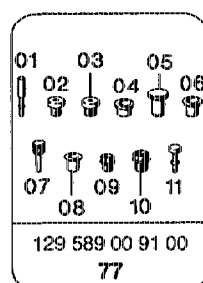
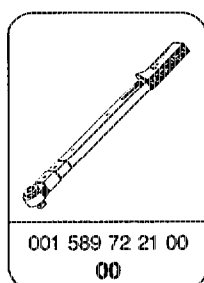
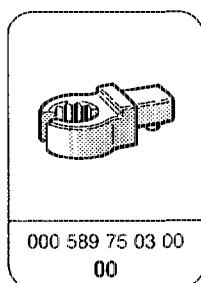

Note

Only use commercially available double ended flat flare nut ring wrench to slacken the brake lines.

Seal hydraulic lines and connections with blind plugs.

Installation note

When installing the hydraulic lines, clean sealing surfaces of swarf and dirt.

Electrical connector (16) must engage audibly when connecting.

Markings on the ASR hydraulic unit (A7/3):

P Pump
E Pressure accumulator input
SP Bleed screw

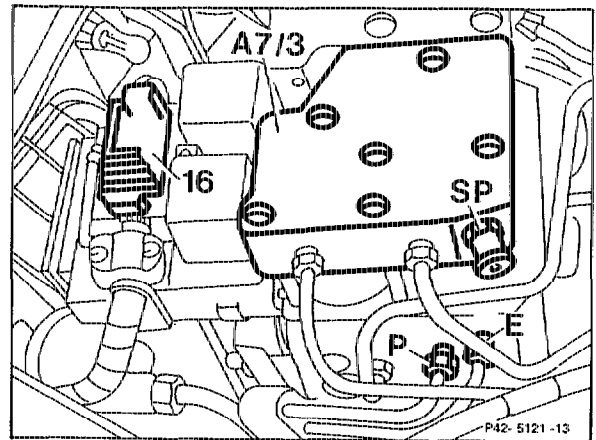

Check line routing:

- Pressure accumulator connection "P" - ASR hydraulic unit (A7/3) connection "P",
- Pressure accumulator connection "E" - ASR hydraulic unit (A7/3) connection "E".

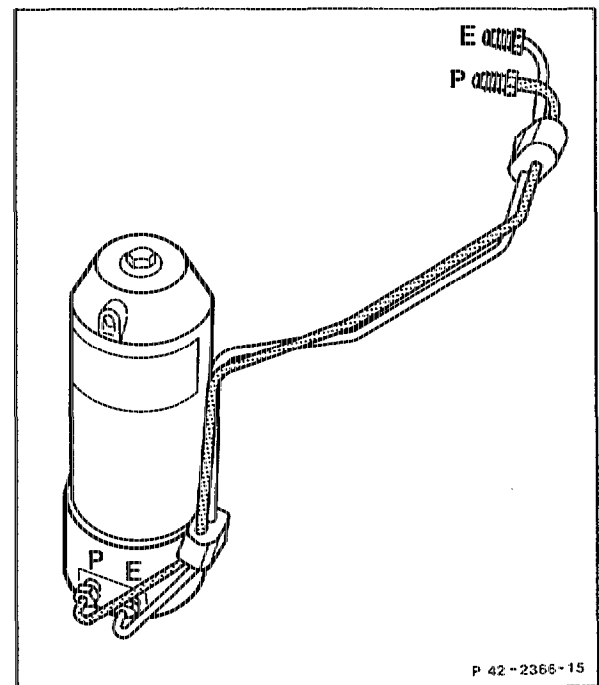

C. Model 140

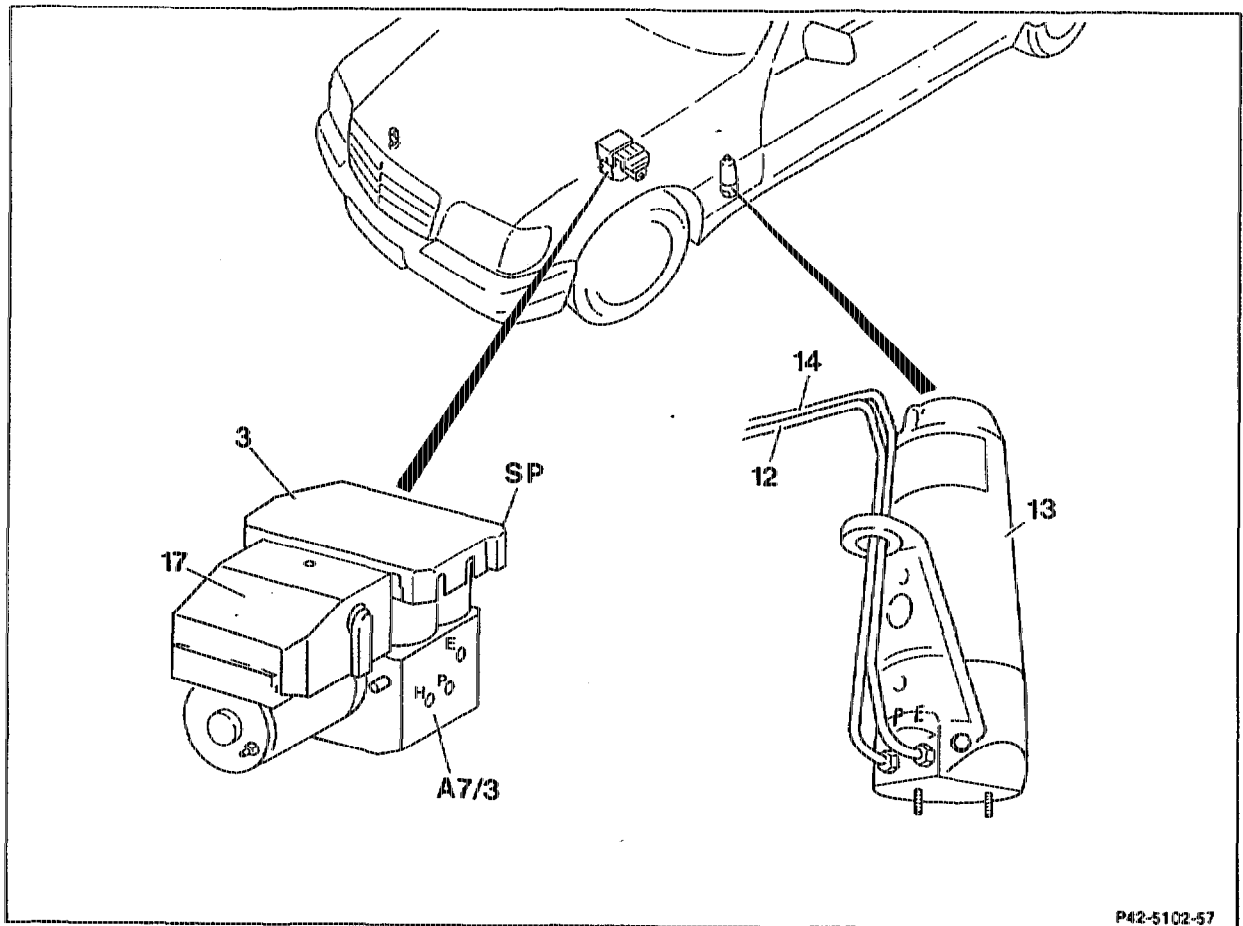

Ignition	OFF.
Cover hoods (3 and 17)	remove, install.
Hydraulic system	depressurize. Open bleed screw "SP" on ASR hydraulic unit (A7/3) approx. 1 turn, drain complete contents of accumulator into the receptacle for brake fluid.
Tension relief	remove, install.
Plug connection	detach from ASR hydraulic unit (A7/3), attach. Follow installation note (item 1)
Hydraulic lines (12, 14)	unscrew, screw on at the pressure accumulator (13). Only use (9 x 11 mm) double ended flat flare nut ring wrench for slackening, 15 Nm. Follow note.

Side panelling	detach, install between driver's door and front fender.
Plastic panelling	detach, assemble.
Stiffening bracket	press to one side, mount.
Pressure accumulator (13)	remove, install. Before installing, align the lines to the pressure accumulator and tighten. Follow installation note (items 2 and 3).
Retaining plate	remove from, install at pressure accumulator.
Hydraulic system	bleed (42-010).
ASR hydraulic test program	perform in accordance with Diagnosis Manual - Chassis.
Fault memory	readout and erase in accordance with Diagnosis Manual - Chassis.

Special tools

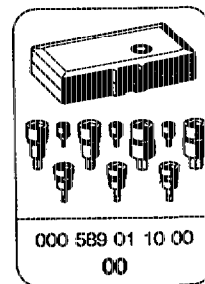
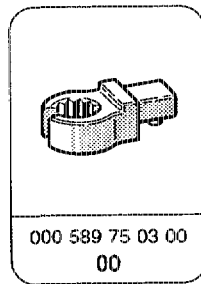
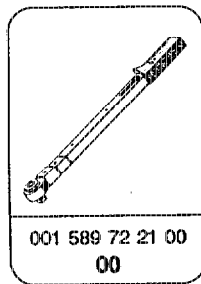
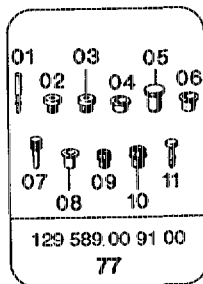

Note

Only use commercially available double ended flat flare nut ring wrench to slacken the brake lines.

Seal hydraulic lines and connections with blind plugs.

When installing the hydraulic lines, clean sealing surfaces of swarf and dirt.

Installation note

- 1 Electrical connector (16) must engage audibly when connecting.

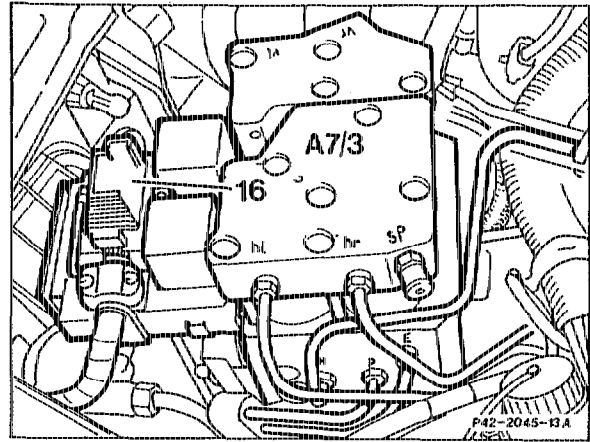

Markings on the ASR hydraulic unit (A7/3):

- P Pump
- E Pressure accumulator input
- SP Bleed screw

- 2 Before installing, align hydraulic lines (12 and 14) to pressure accumulator (13) and tighten.

3 Checking line routing:

- Pressure accumulator connection "P" - ASR hydraulic unit (A7/3) connection "P",
- Pressure accumulator connection "E" - ASR hydraulic unit (A7/3) connection "E".

