

43-0325 Checking brake booster

Operation no. of operation texts and work units or standard texts and flat rates:
43-1031

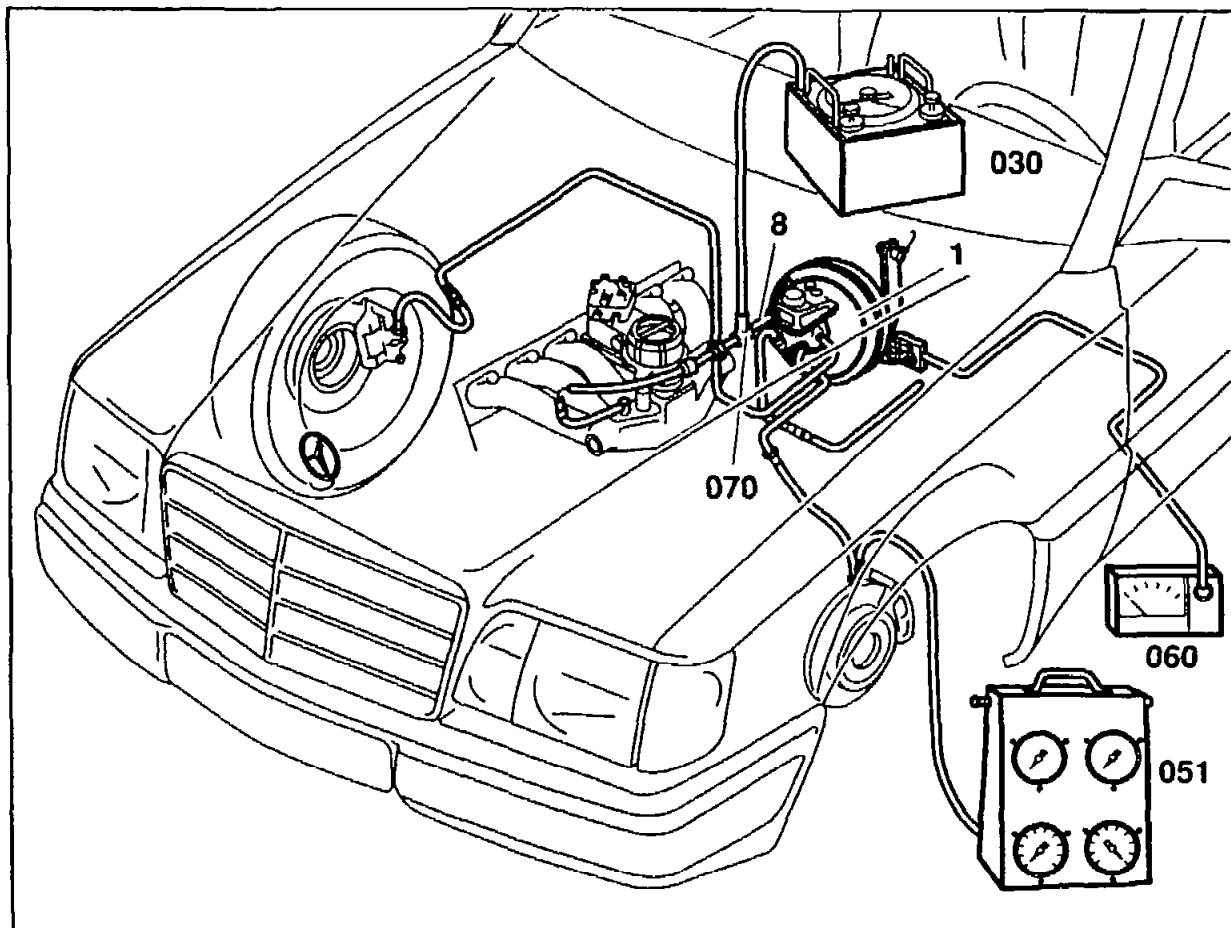

P42-5326-57

- | | |
|-------------------------------------|---|
| Vacuum line (8) | unscrew at brake booster (1), screw on, 30 Nm. |
| Test connection (070) | screw on between brake booster (1) and vacuum line (8), unscrew. Test connection (070) shop-made. |
| Tester (030) 201 589 13 21 00 | connect to test connection (070), disconnect. |
| (Pressure tester 051) | connect to brake caliper, disconnect, after unscrewing bleed screw. Bleed pressure tester (051). After testing bleed only brake caliper to which pressure tester (051) was connected (42-0010). |

Pedal force gauge (060)	install on brake pedal, remove.
Check brake booster as follows	Allow engine to run and create a vacuum of 0.75 – 0.8 bar by depressing and suddenly releasing accelerator pedal. If the vacuum achieved is significantly lower or if the vacuum decreases immediately, the O-ring between the brake booster (1) and tandem master brake cylinder may be damaged or the check valve in the vacuum line (8) may be defective. On vehicles with diesel engine - check vacuum pump (07.1-160)
Brakepedal	depress with specified force, read off line pressure (see Table).

Note

In order to allow for measuring errors (wrong force on brake pedal, wrong vacuum) and fluctuations of the testing devices, a tolerance of ± 10 bar from the specified value is permissible. Replace brake booster according to condition (43-0350). Test check valve for leakage (43-0023).

Data

Model	Brake booster ²⁾	Booster dia.	Boost factor approx.	Force curve: Line pressure in bar with force on brake pedal and vacuum of 0.75 – 0.8 bar				
				50 N	100 N	150 N	200 N	250 N
124 ¹⁾ RL 201.029/035	ATE T52/4A/ 255 Lucas LSC 80	254 mm 10"	3,85	10 – 16	26 – 35	43 – 54	59 – 70	75 – 85
201.023/024/028/122/126 1st version up to 08/88	Lucas LSC50 DBA Isovac	203 mm 8"	3,4	5 – 11	20 – 31	35 – 50	54 – 65	70 – 76
201.023/024/028/122/126/128 2nd version as of 09/88 201.018	Lucas LSC85 Bendix	228.6 mm 9"	3,85	7 – 15	26 – 38	43 – 58	62 – 75	78 – 88
124.027/029/127/129 LHD 124.003/004/007/008 LHD 124.104/105/106/107 LHD 201.029/035 201.128 1st version up to 08/88	ATE T52/4A/ 225 – 210	203/ 228.6 mm 8"/9"	4,5	10 – 18	25 – 38	42 – 58	59 – 78	75 – 97
124.034/036 201.036	ATE T52/4A 225 – 210 Lucas LSC115	203/ 228.6 mm 8"/9"	5,6	14 – 25	35 – 45	53 – 63	71 – 81	87 – 98

1) Not 124.027/029/034/036/127/129,
LHD 124.003/004/007/008/104/105/106/107.

2) Girling company designation replaced by Lucas.

Special tool

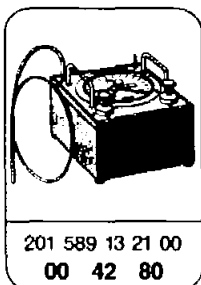

Commercially available tools and testers

Designation	e.g. Messrs., order no.
Pressure tester (051)	ATE, D-60480 Frankfurt/M. Order no. 3 9305-1020.4
Pedal force gauge (060)	Bosch, D-73207 Stuttgart Order no. BSA 100

Shop-made tool

Fabricate test connection according to drawing (parts 1, 3, 4, 5 and 6 are brazed together).

