

46-0238 Removing, installing and checking control valve

Preceding work:

Removing and installing steering gear (46-3400).
Removing and installing bearing cover with pitman arm shaft (46-0232).
Removing and installing play compensator (46-0235).
Removing and installing steering shaft/bearing cover (46-0236)

A. Conventional control valve

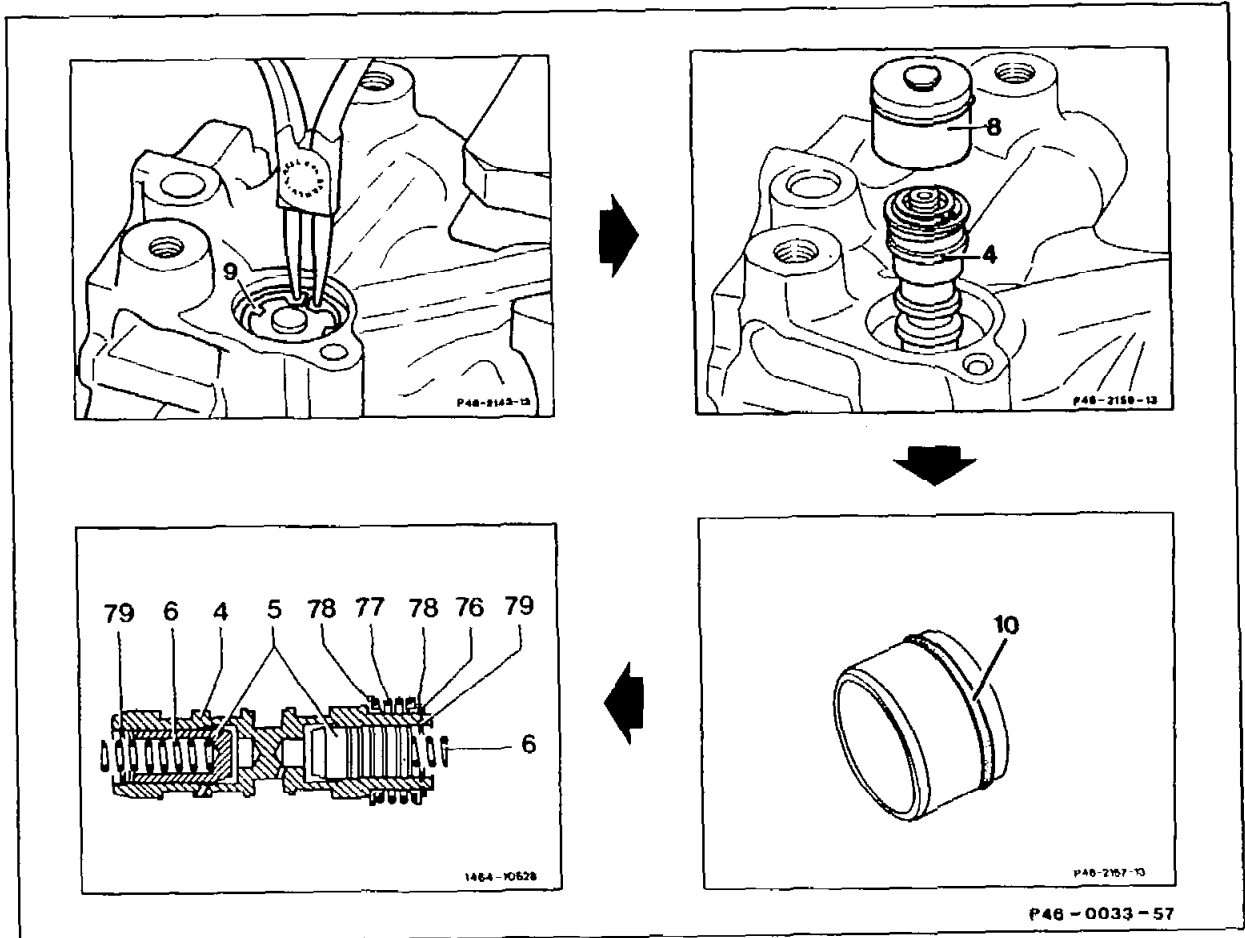

Locking ring (9)

withdraw from steering gear housing. When inserting locking ring, ensure that the lugs press onto the end cover and the locking ring is properly seated in the groove.

- End cover (8) withdraw from steering gear housing, replace O-ring (10). When inserting end cover, ensure that the hole in the end cover is facing upwards in the installed position.
- Control valve (4) withdraw from the steering gear housing. Ensure that the springs (6) do not drop out of the reaction piston. Before inserting control valve (4) in the steering gear housing, insert springs (6) with grease into the reaction pistons.

Note

The control valve has been fitted to the steering gear by adopting the selection procedure. If the control valve does not move easily or sticks, or if there are signs of wear on the surface, the steering gear should be replaced.

- Springs (6) check. If a spring is fractured, the steering gear must be replaced. It is **not** possible to achieve uniform steering assistance with one replacement spring. The springs must remain allocated to the respective side when removing and installing the reaction piston.

- Reaction piston (5) check that it operates freely in control valve (4). The compensating washers of the two reaction pistons must not be mixed up.



Do not disassemble reaction piston (5).

- Locking ring (79) ensure it is correctly seated.
- Spring (77) check.

B. Control valve on parameter steering

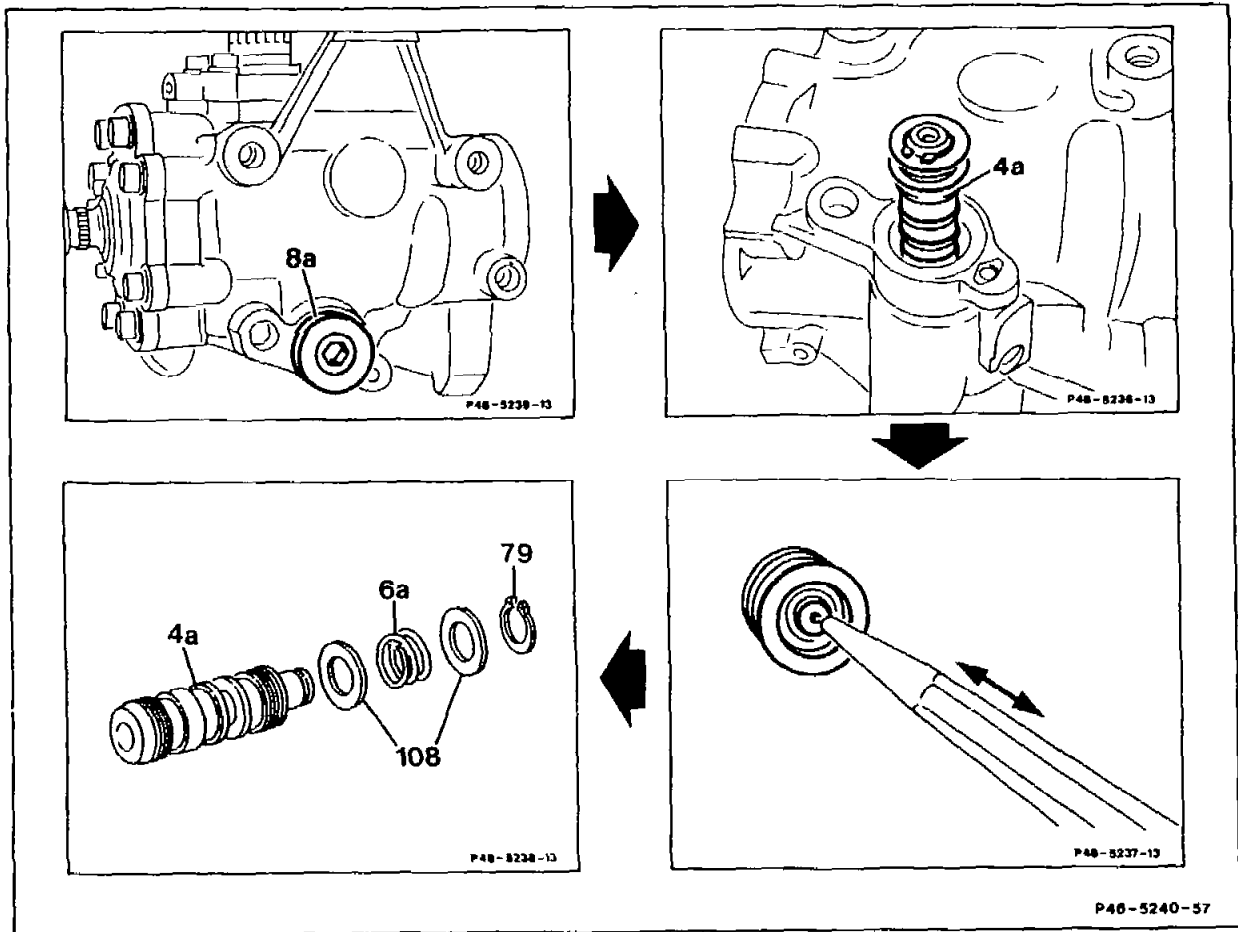

Screw plug (8a)
 Control valve (4a)

unscrew, screw in, 100 Nm, replace seal.
 remove, install at steering gear.

Note

The control valve has been fitted to the steering gear by adapting the selection procedure. If the control valve does not move easily or sticks or if there are signs of wear on the surface, the steering gear should be replaced.

Springs in reaction piston check. Press these against the spring force using a mandrel and check whether the reaction piston is pressed back properly into the final position.



If the reaction piston does not move back properly or the spring is broken, the steering gear must be replaced since even steering assistance is **not** possible with a replacement spring.

Locking ring (79) remove, check, install, replace if required.
Thrust washers (108) remove, check, install, replace if required.
Basic pressure spring (6a) check for coil fracture.