

72-270 Testing and replacing microswitch (T-sedan)

Door lock on tailgate removed (72-265)

Special tool



Conventional testers

Multimeter

e.g. Sun, DMM-5
e.g. Avometer
e.g. Fluke 23

Test condition:

Battery voltage on closing assist plug connection tailgate (A 12x) bushing 2 (+) and bushing 3 (-) in place.

Complaint:

- Closing assist not functioning
- Interior lights (dome lights) at the rear not extinguishing (switch for dome lights (S 18/1) in position II)



B. Replacing microswitches

Note

1st version up to 06/86 without microswitch plug connection (A 12s1s2x):

Both microswitches are available as a spare part with soldered-on lines and plug connection (A 12s1s2x).

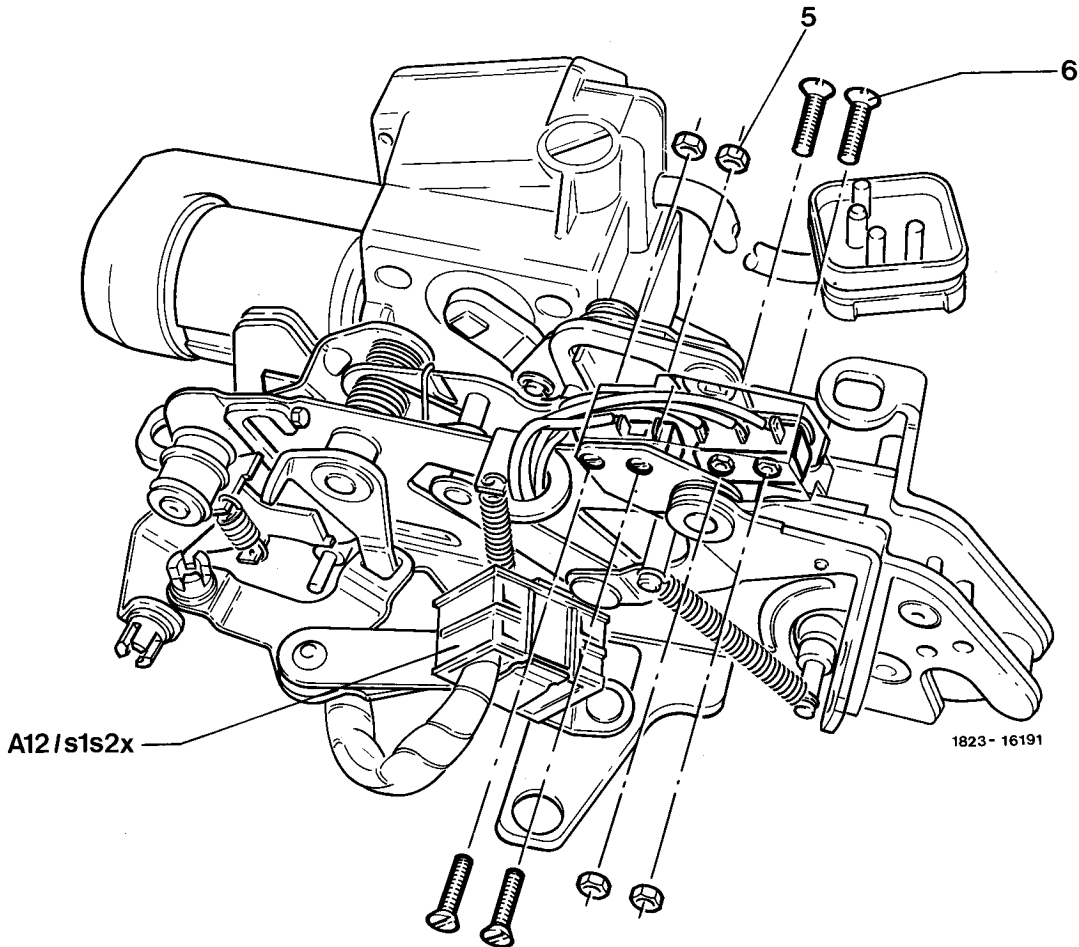

Removing, installing

| | |
|--|-------------------------|
| On 1st version up to 06/86 lines on both microswitches | unsolder |
| On 2nd version as of 06/86 microswitch plug connection (A 12s1s2x) | disconnect |
| Lock, 2 screws | unscrew and remove lock |
| Rivets on sheet metal side | bore out |

| | |
|---|---------------|
| Microswitch with countersunk screws (6) and nuts (5) | fasten |
| Nuts with screw locking means 002 989 94 71 .. | lock |
| On 1st version, lines on both new microswitches . | unsolder |
| Lines of old microswitches, as found | solder-on |
| On 2nd version microswitch plug connection (A 12s1s2x) | plug together |
| Cover above microswitches | plug on. |

A. Testing microswitches

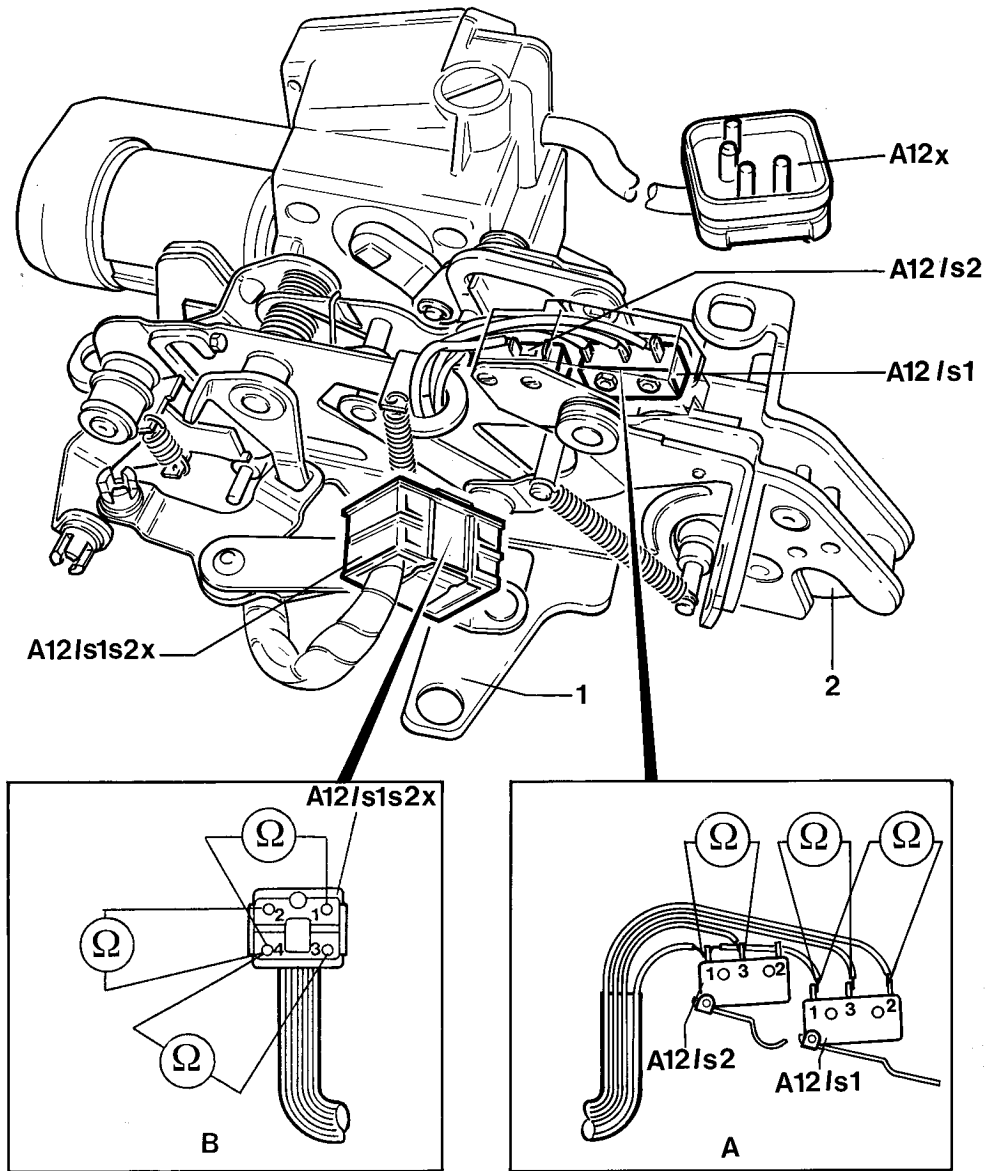

1823 - 16231

Vehicles up to approx. 06/86

- | | |
|--|---------|
| Door lock on spot designated 1 on drawing in vise | clamp |
| Cover over microswitch, left and right | unclip |
| Multimeter according to drawing cutout (A) and table | connect |
| Rotary latch (2) according to table | actuate |

| Actuation rotary latch | Connection | | Multimeter to microswitch | | | |
|------------------------|------------|----------|---------------------------|----------|--------|----------|
| | | | A 12s1 | | A 12s2 | |
| | No. | Ω | No. | Ω | No. | Ω |
| open | 1-2 | ∞ | 1-3 | 0-1 | 1-3 | 0-1 |
| 1st detent | 1-2 | 0-1 | 1-3 | ∞ | 1-3 | 0-1 |
| 2nd detent | 1-2 | 0-1 | 1-3 | ∞ | 1-3 | ∞ |

In the event of deviation from values on table, replace microswitch.

Vehicles as of approx. 06/86

Door lock on spot identified with 1 in vise clamp
 Plug connection microswitch tailgate
 (A 12s1s2x) disconnect
 Multimeter according to drawing cutout (B) and
 table connect
 Rotary latch (2) according to table actuate

| Actuation rotary latch | Connection Multimeter to A 12s1s2x | | |
|------------------------|------------------------------------|-----------------|-----------------|
| | Bushing 1-4 | Bushing 2-4 | Bushing 3-4 |
| open | $\infty \Omega$ | 0-1 Ω | 0-1 Ω |
| 1st detent | 0-1 Ω | $\infty \Omega$ | 0-1 Ω |
| 2nd detent | 0-1 Ω | $\infty \Omega$ | $\infty \Omega$ |

In the event of deviation from data named in table, replace microswitch.