

77-440 Removal, installation and adjustment of soft top compartment cover switches "closed" and "locked"

Operation no. of operation texts and work units or standard texts and flat rates:

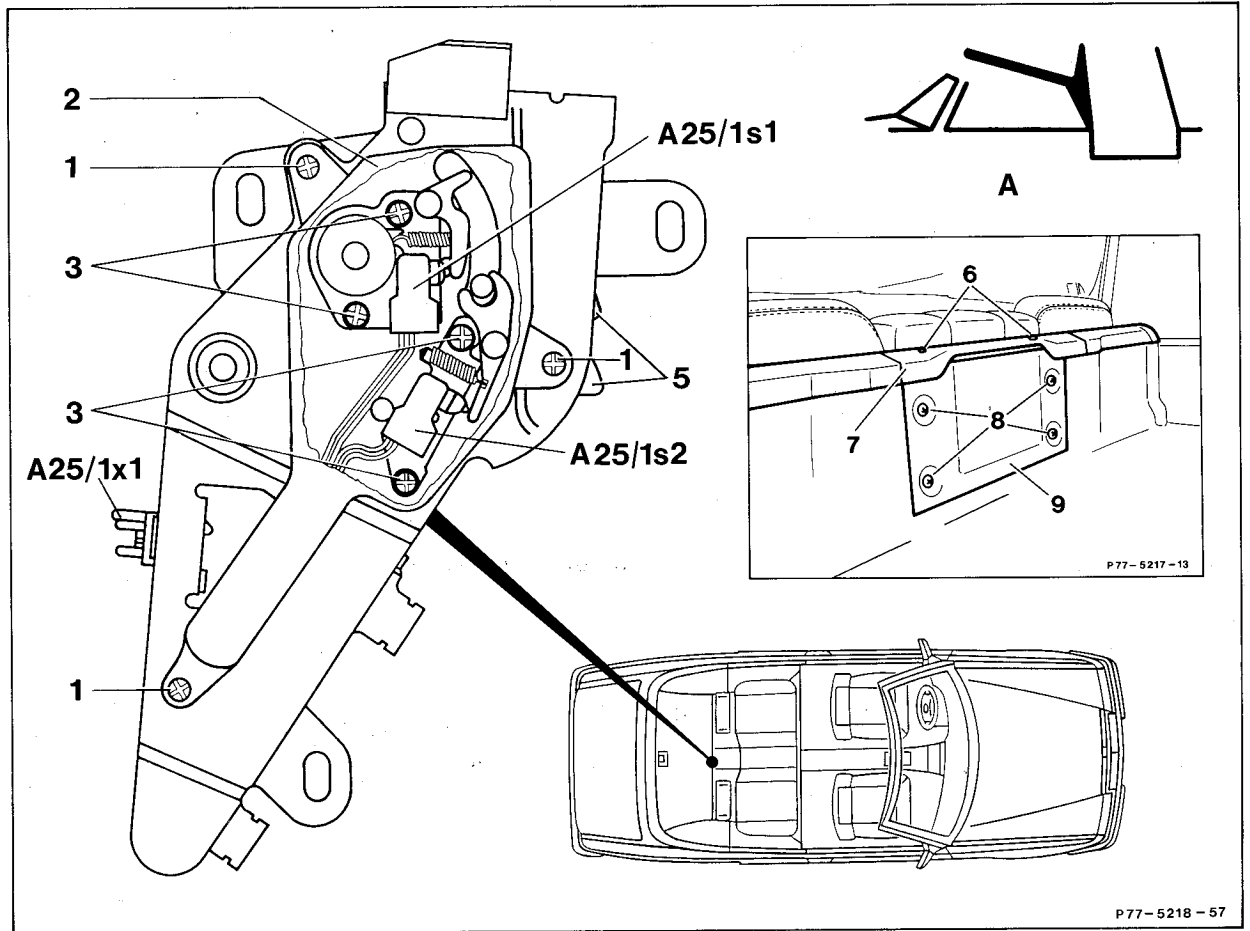

Soft top compartment cover	open, close.
Soft top bow	put up (position A), put down.
Ignition key	remove.
Screws (6)	unscrew, screw in.
Plastic cover (7)	remove, install.
Screws (8)	unscrew, screw in.
Sheet metal cover (9)	remove, install.
Hydraulic lines on lock	detach, fasten.
Lock	unscrew, screw on.
Lock	clamp into vise, remove.

Lock	
Screws (1)	
Cover (2)	
Screws (3)	
Plug connection (A25/1x1)	
Soft top compartment cover switch "closed" (A25/1s1) and soft top compartment cover switch "locked" (A25/1s2)	
Switches (A25/1s1, A25/1s2)	

lock with soft top key, unlock.

Note

When actuating the locks in the removed state cover the connections for the hydraulic lines. When unlocked a lock can be locked by pushing the rotary catch (5) down with a screwdriver (overcoming first detent), until it can be locked with the soft top key (vehicle tool kit).

unscrew, screw in.
remove, install.
unscrew, screw in.
unclip from holder, clip in.
remove, install.
adjust (item 1).

Shop-made tools

Cut paper strips according to drawing and mark.

- A = 5 mm
- B = 5 mm
- C = 7.5 mm
- D = 8.5 mm
- E = 51 mm
- F = 53 mm
- G = 60 mm

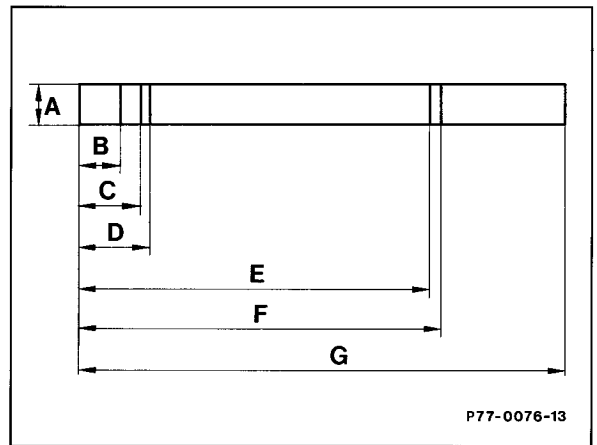

- X: Main detent
- Y: Switching range (2.5 – 3.5 mm before main detent catch)
- Z: Switching range (46 – 48 mm before main detent catch)

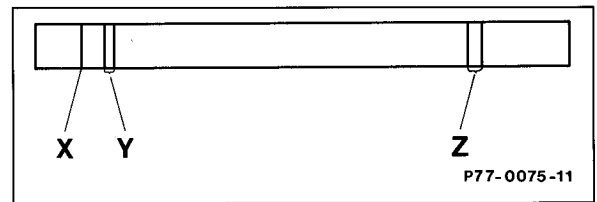

1 Glue paper strips onto lock so that the top edge of the rotary catch (5) forms a line with the main detent (X) in the locked state (push rotary catch upward with thumb to eliminate play).

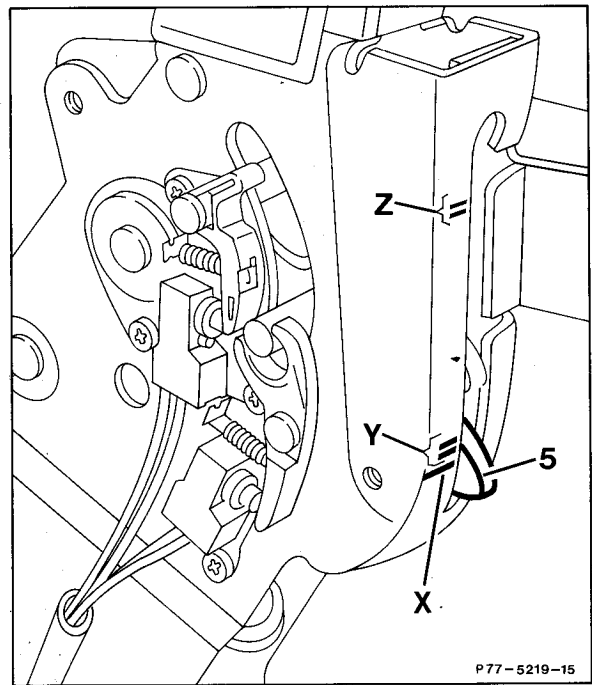

Unlock lock. Connect multimeter to plug connection (A25/1x1, pins 3 and 4). Set multimeter to continuity test (acoustic signal). Press lock in direction "lock" with soft top key (vehicle tool kit). Simultaneously press rotary catch (5) upward with thumb to eliminate play. Soft top compartment cover switch "locked" (A25/1s2) should switch when the upper edge of the rotary catch (5) is in the switching range (Y). Adjust by moving in oblong holes, if required.

Note

Secure mounting screws (3) with paint.

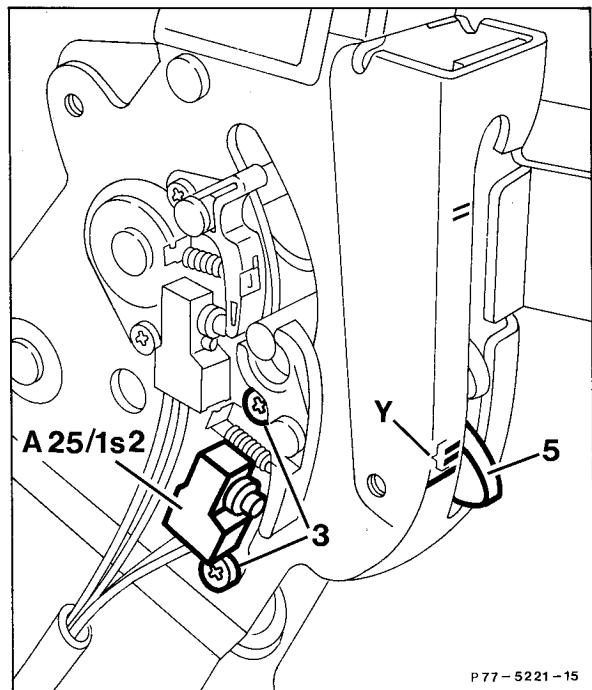

Unlock lock, connect multimeter to plug connection (A25/1x1, pins 1 and 2). Set multimeter to continuity test (acoustic signal). Press lock in direction "lock" with soft top key (vehicle tool kit). Simultaneously press rotary catch (5) upward with thumb to eliminate play. The soft top compartment cover switch "closed" (A25/1s1) should switch when the upper edge of the rotary catch (5) is in the switching range (Z). Adjust by moving in oblong holes if required.

Note

Secure mounting screws (3) with paint.

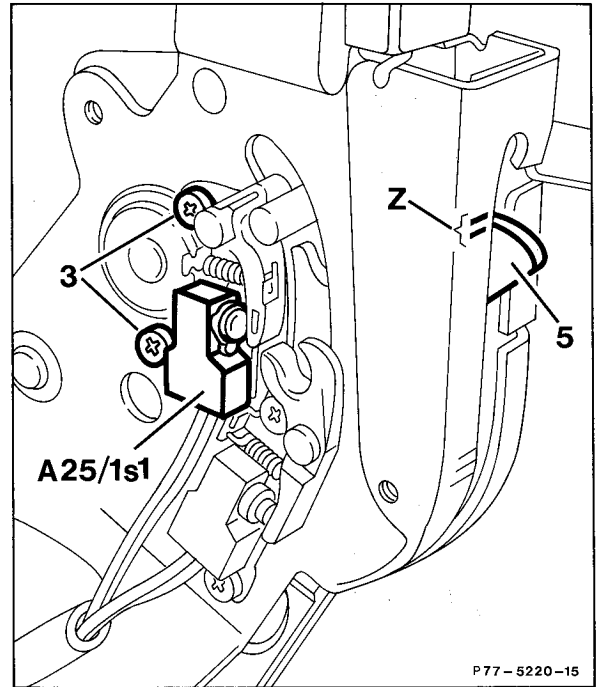

P77 - 5220-15