

80-215 Removing and installing actuator (S47, S48, S49)

Preceding operation:

Checking electrical function of central locking system (80-104)
 Checking central locking system for leaks (80-120)

Operation no. of operation texts and work units
 or standard texts and flat rate \$0-0300, 80-0301, 80-0304, 80-

A. Front doors

a) Sedan and Station Wagon up to Vehicle Ident End No. A 391255/F 025885

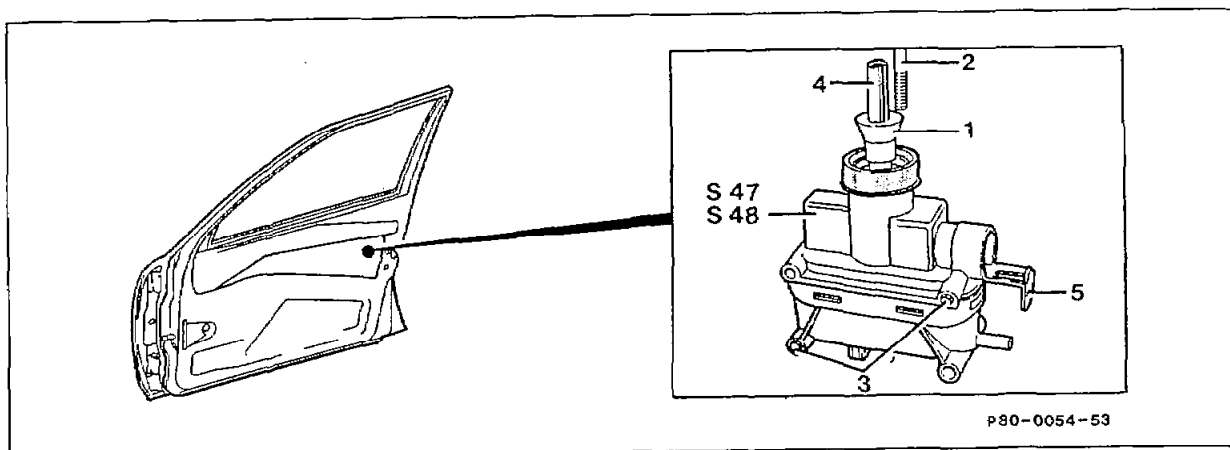

Door panelling luggage compartment lining	remove.
Sliding sleeve (1)	push back.
Shift rod (2)	press out.
Bolts (3)	slacken.
Actuator (S47, S48, S49)	detach.
Strain relief (5)	press away.
Electric lead and pneumatic line	disconnect.
Electric or pneumatic function of actuator (S47, S48)	check (80-112) or (80-116).
Move actuator (S47, S48) into installation position	push sliding sleeve (1) back fully and withdraw shift rod mounting (4) as far as detent.
Actuator	install in the reverse order.

b) Sedan and Station Wagon from Vehicle Ident End No. A 391256/F 025886

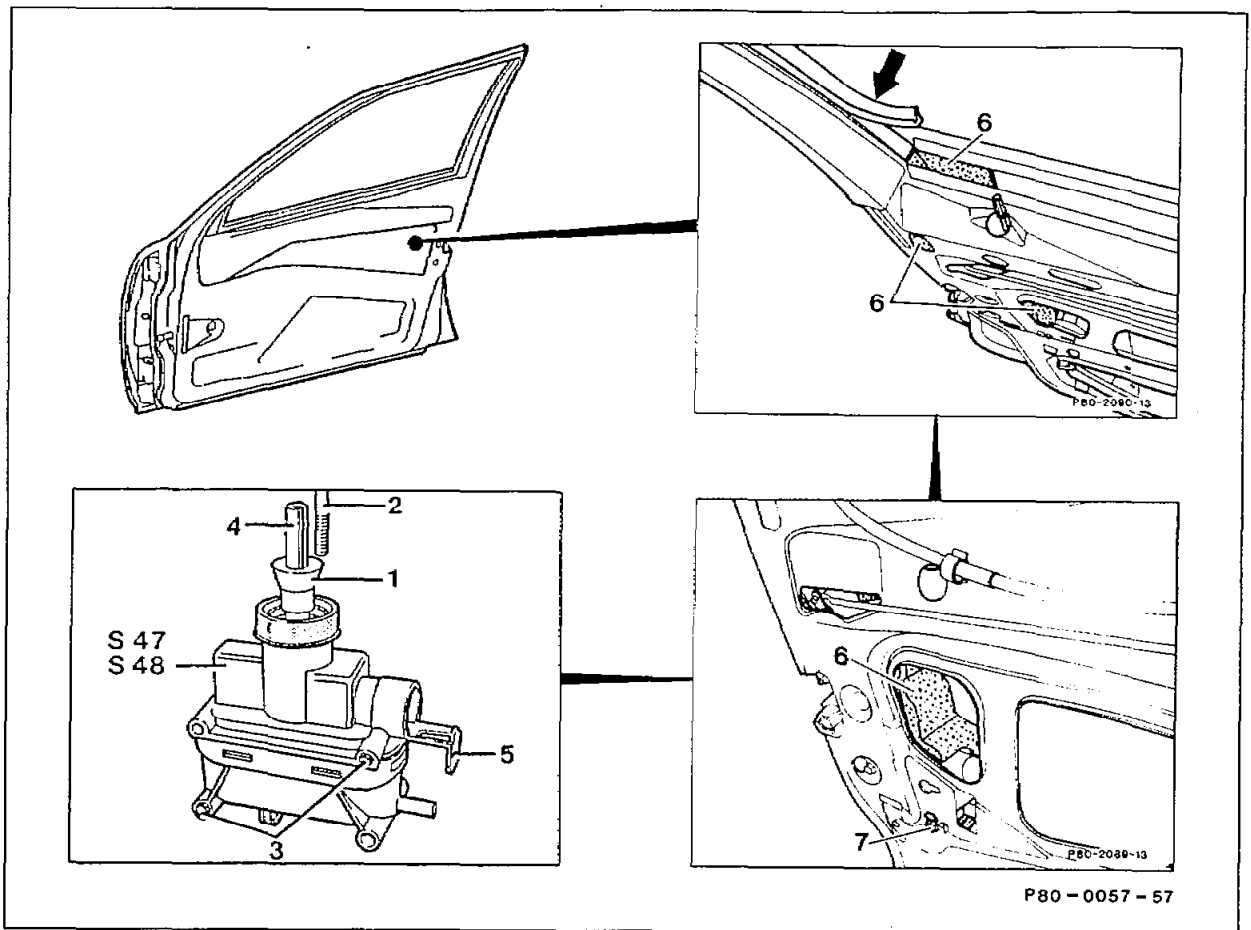

Door panelling	remove.
Crank window	slacken and move into door shaft.
Sealing rail on window guide	withdraw slightly down the way.
Bolt (7)	unscrew.
Cover (6)	take off.
Sliding sleeve (1)	push back.
Shift rod (2)	press out.
Bolt (3)	slacken.
Actuator (S47, S48)	detach.
Strain relief (5)	push away.
Electric lead and pneumatic line	disconnect.
Electric or pneumatic function of actuator (S47, S48)	check (80-112) and (80-116).
Actuator (S47, S48), move into installation position	push sliding sleeve (1) back fully and withdraw shift rod mounting (4) as far as detent.
Actuator	install in reverse order.

c) Coupé and cabriolet

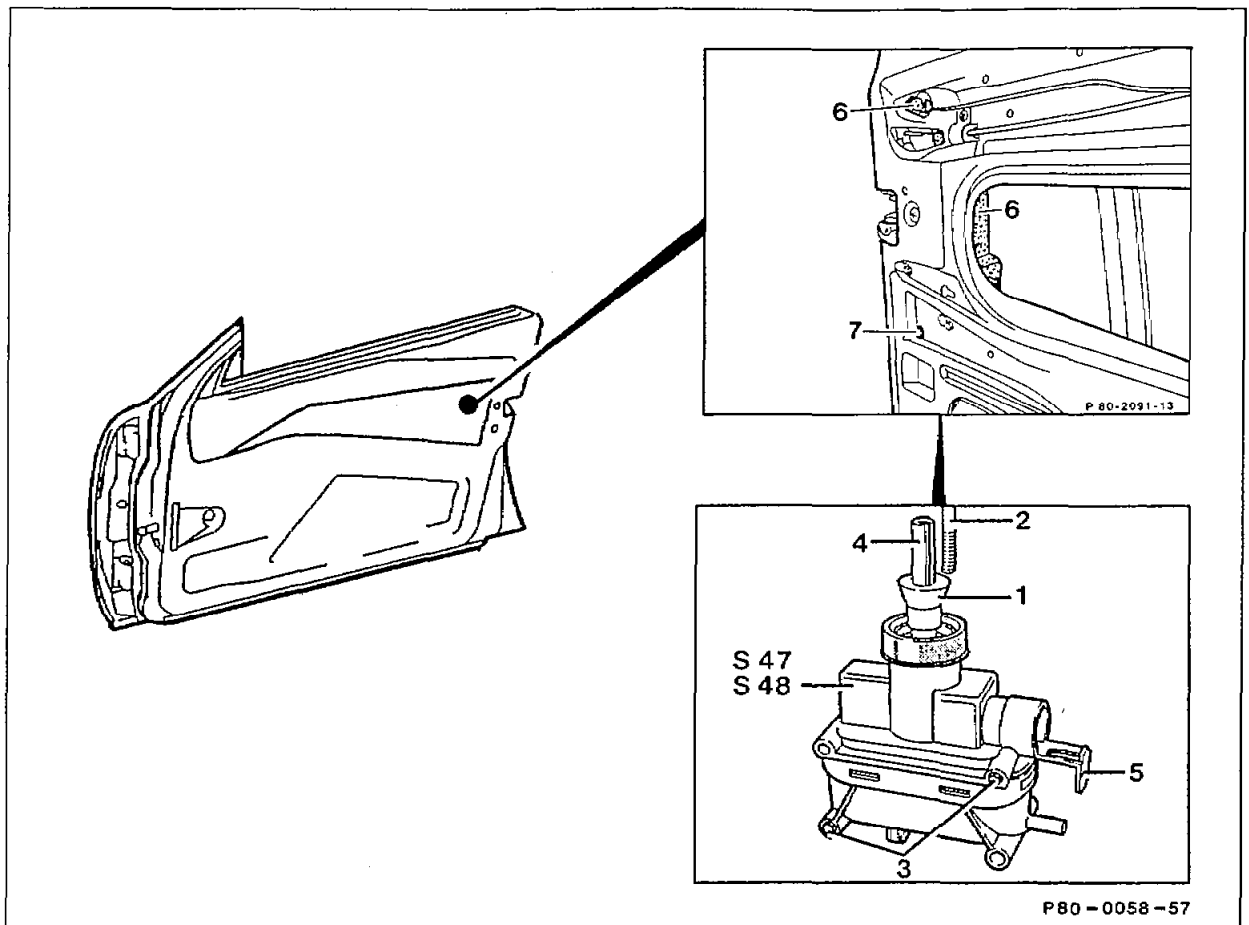

Door panelling	remove.
Bolt (7)	unscrew.
Cover (6)	take off.
Sliding sleeve (1)	push back.
Shift rod (2)	push out.
Bolt (3)	slacken.
Actuator (S47, S48)	detach.
Strain relief (5)	push away.
Electric lead and pneumatic line	disconnect.
Electric or pneumatic function of actuator (S47, S48)	check (80-112) and (80-116).
Actuator (S47, S48), move into installation position	push sliding sleeve (1) back fully and withdraw shift rod mounting (4) as far as detent.
Actuator	install in reverse order.

B. Tailgate

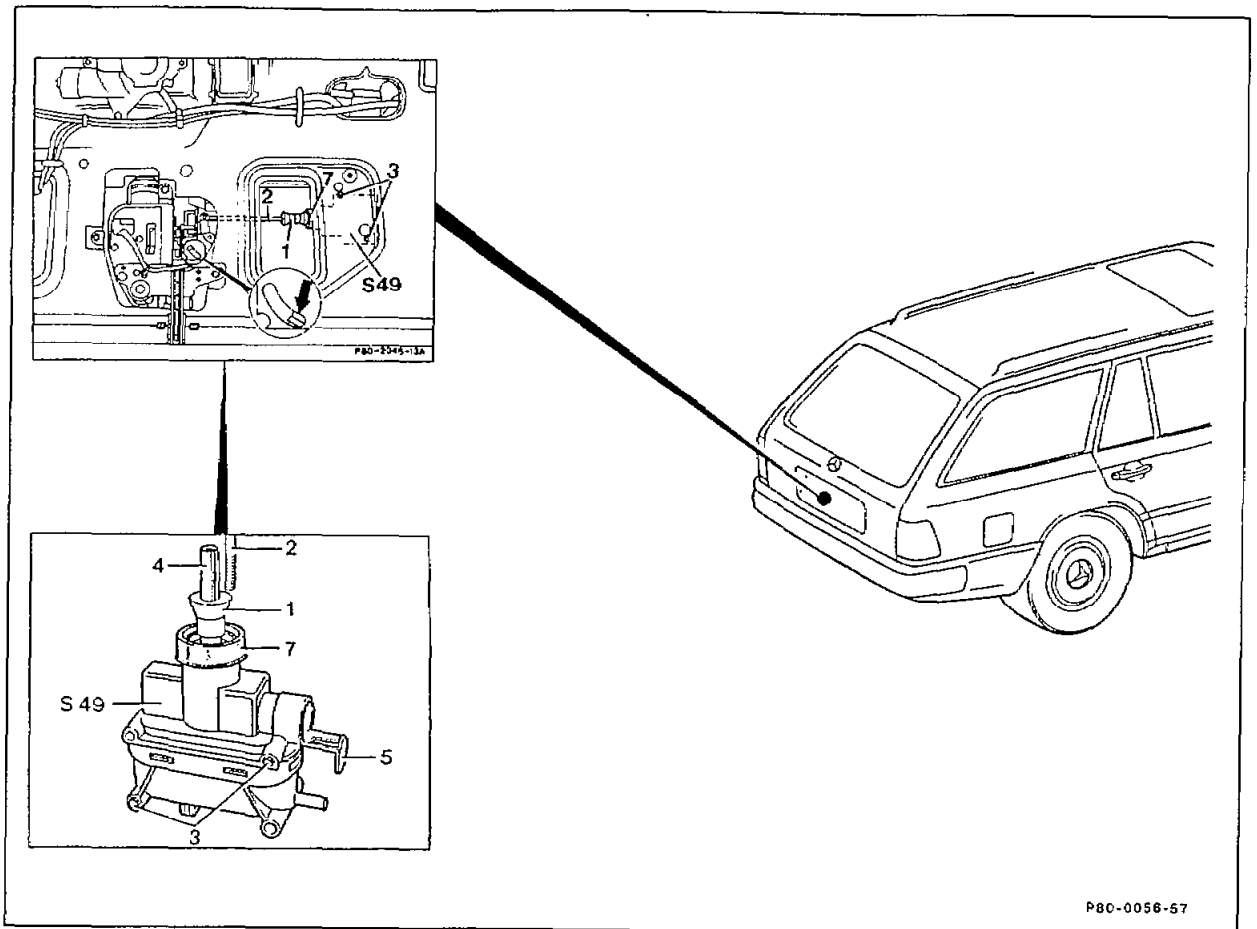

Door panelling	remove.
Sliding sleeve (1)	push back.
Shift rod (2)	push out.
Bolt (3)	slacken.
Actuator (S49)	detach.
Strain relief (5)	push away.
Electric lead and pneumatic line	disconnect.
Electric or pneumatic operation of actuator (S49)	check (80-112) or (80-116).
Actuator (S49), move into installation position	push sliding sleeve (1) back fully and withdraw shift rod mounting (4) as far as detent. Push shift rod (2) away from actuator up to stop (arrow) when installing.
Actuator	install in reverse order.



Install only actuators with **black** rubber cup seal (7).

C. Trunk lid

a) Sedan

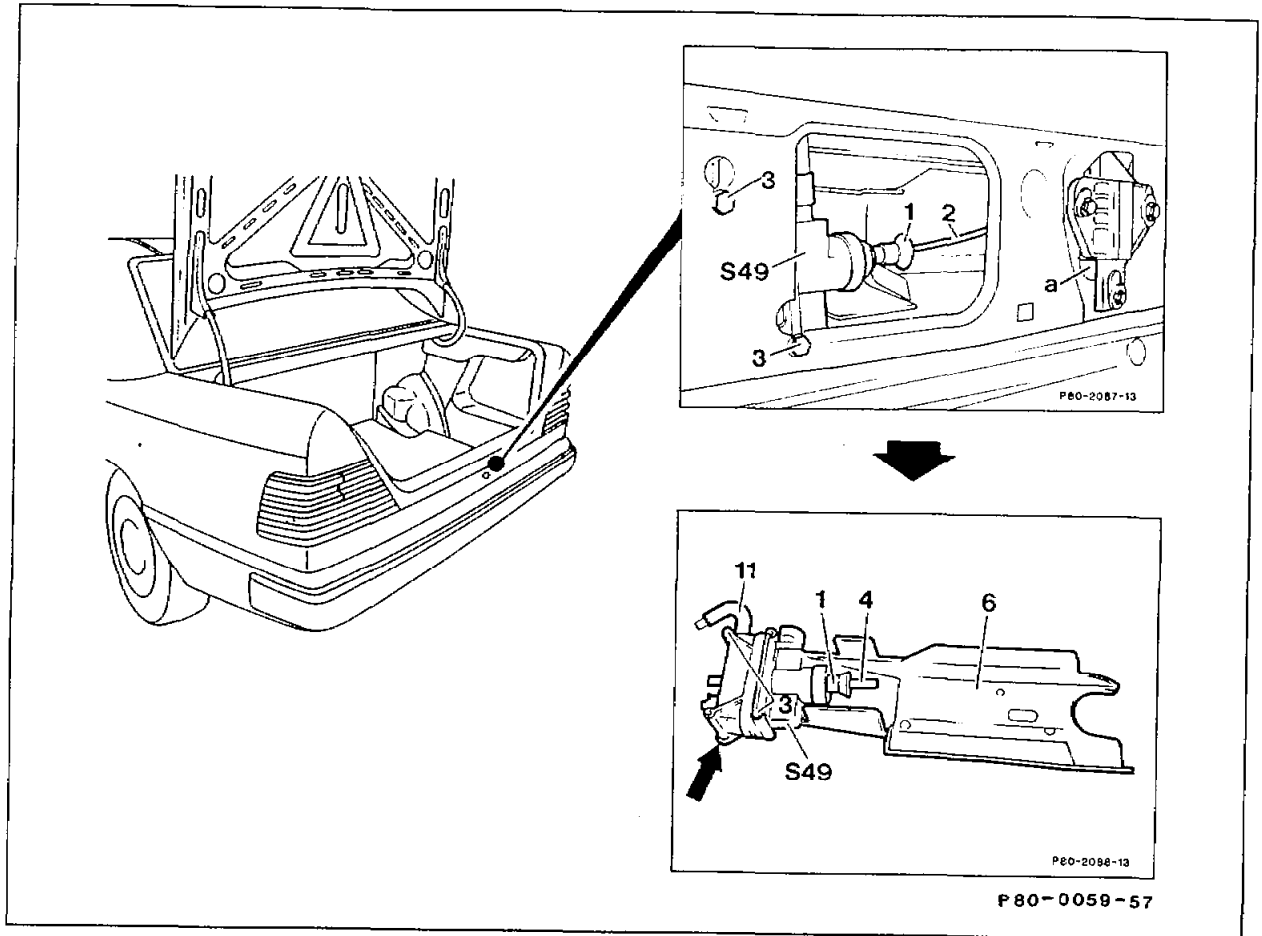

Trunk panelling at rear centre section	remove.
Sliding sleeve (1)	push back.
Shift rod (2)	push out.
Bolt (3)	slacken.
Actuator (S49) with cover (6)	detach and remove.
Electric lead and pneumatic line	disconnect.
Cover (6)	unscrew (arrow).
Electric or pneumatic function of actuator (S49)	check (80-112) or (80-116).
Actuator (S49), move into installation position	push sliding sleeve (1) back fully and withdraw shift rod mounting (4) as far as detent. When installing, push shift rod (2) up to stop away from actuator.
Actuator	install in reverse order.
	
	On vehicles with trunk lid auxiliary locking device, install actuators only with red shift rod mounting.

b) Coupé and cabriolet

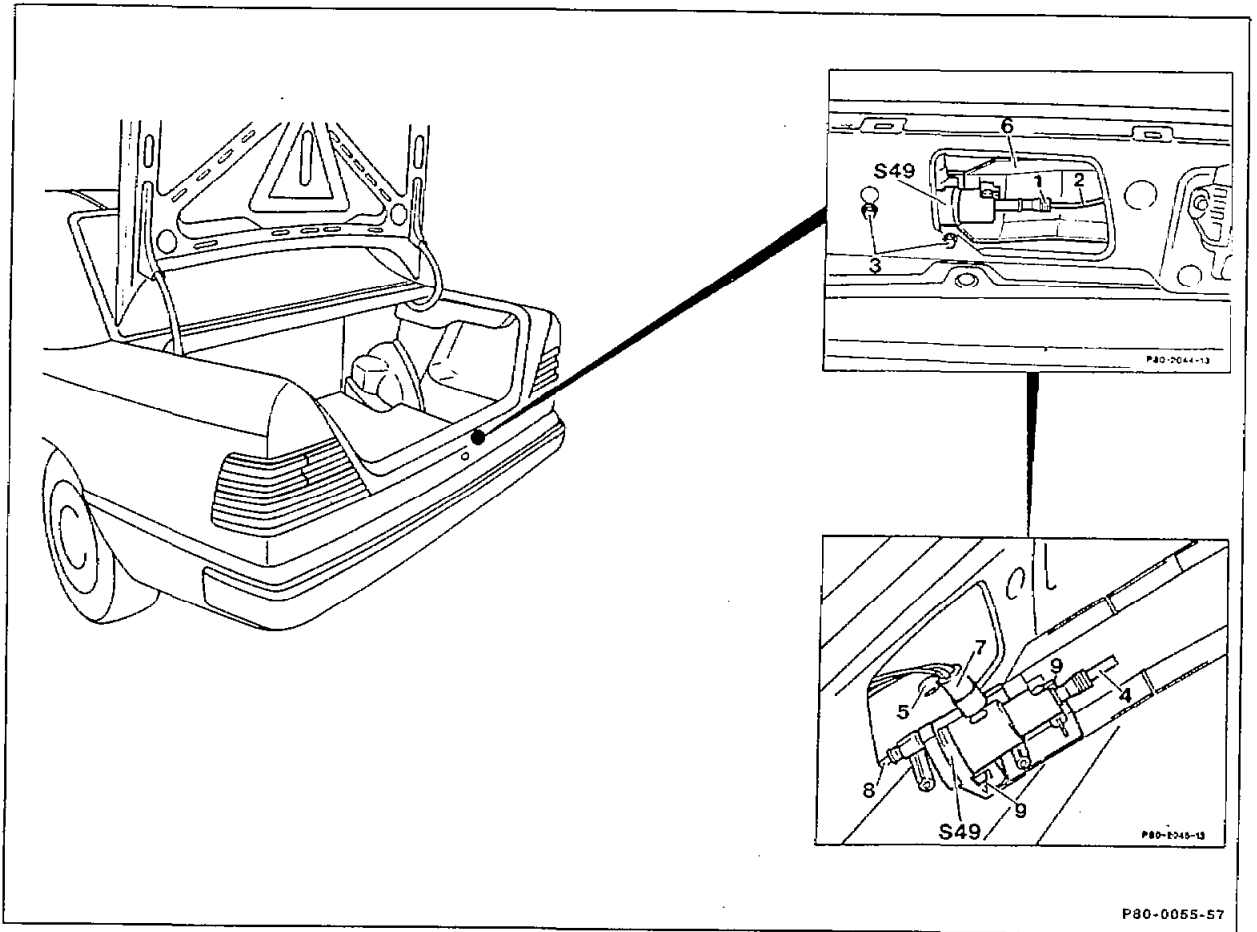

Trunk panelling at rear centre section	remove.
Sliding sleeve (1)	push back.
Shift rod (2)	press out.
Bolt (3)	slacken.
Actuator (S49)	detach.
Actuator (S49) with cover (6)	withdraw through opening in rear centre section.
Strain relief (5)	press away.
Electric lead (7)	disconnect.
Pneumatic line (8)	lever off from connection with open-end wrench (waf 7).
Electric or pneumatic function of actuator (S49)	check (80-112) or (80-116).

Actuator (S49), move into installation
position

Actuator

push sliding sleeve (1) back fully and withdraw
shift rod mounting (4) as far as detent. Push
shift rod (2) of trunk lid lock actuator (S49) up to
stop away from actuator.

install in reverse order.



On vehicles with trunk lid auxiliary locking
device (coupé only), install actuators only with
red shift rod mounting.