

91-070 Removal and installation of guide rail for head restraint

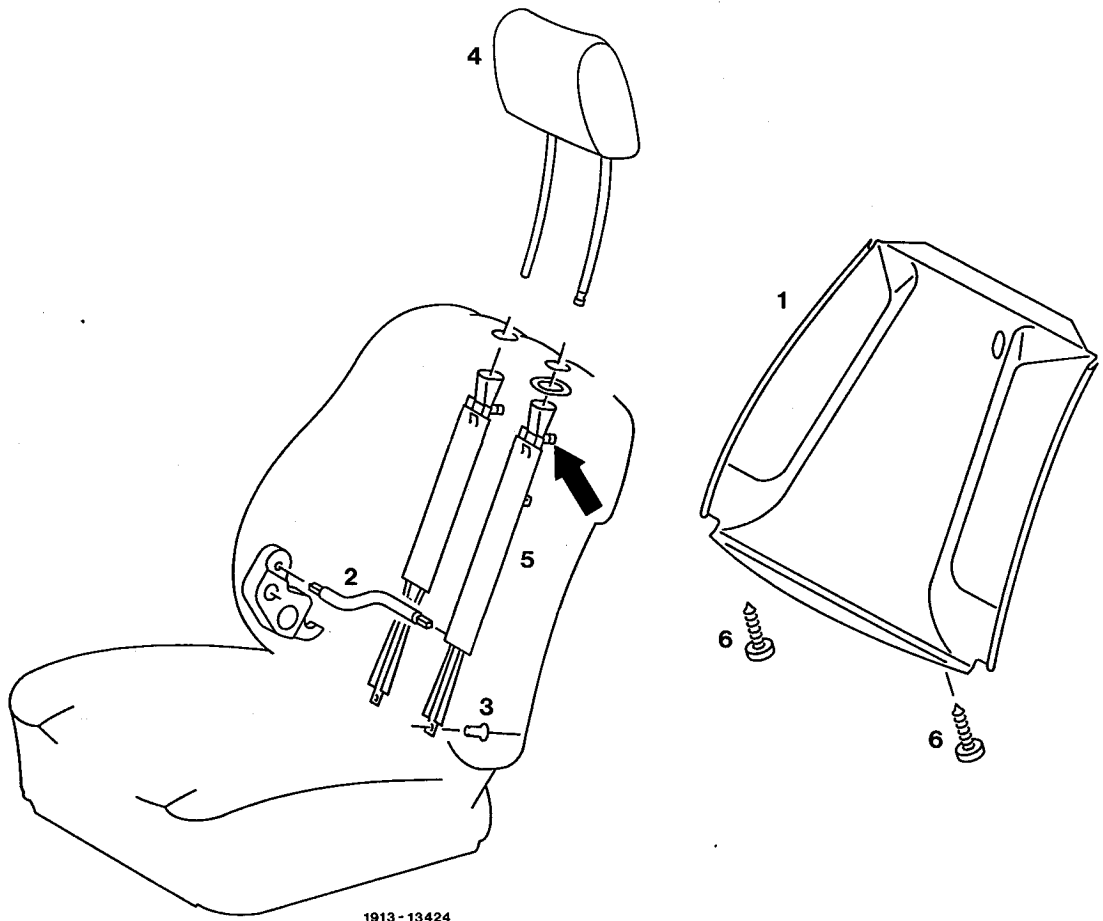

1913-13424

Head restraint (4)	remove and install
Clamping member (1)	remove and install (91-190)
Flexible shaft (2)	pull out at guide rail (5)
Rivet (3)	separate
Guide rail (5)	disconnect at backrest frame top (arrow) and take out
Guide rail (5)	insert at top into backrest frame (arrow) and fasten with rivet (3) below

For further installation proceed vice versa.